

12 DMC 135-180

12DMC 148

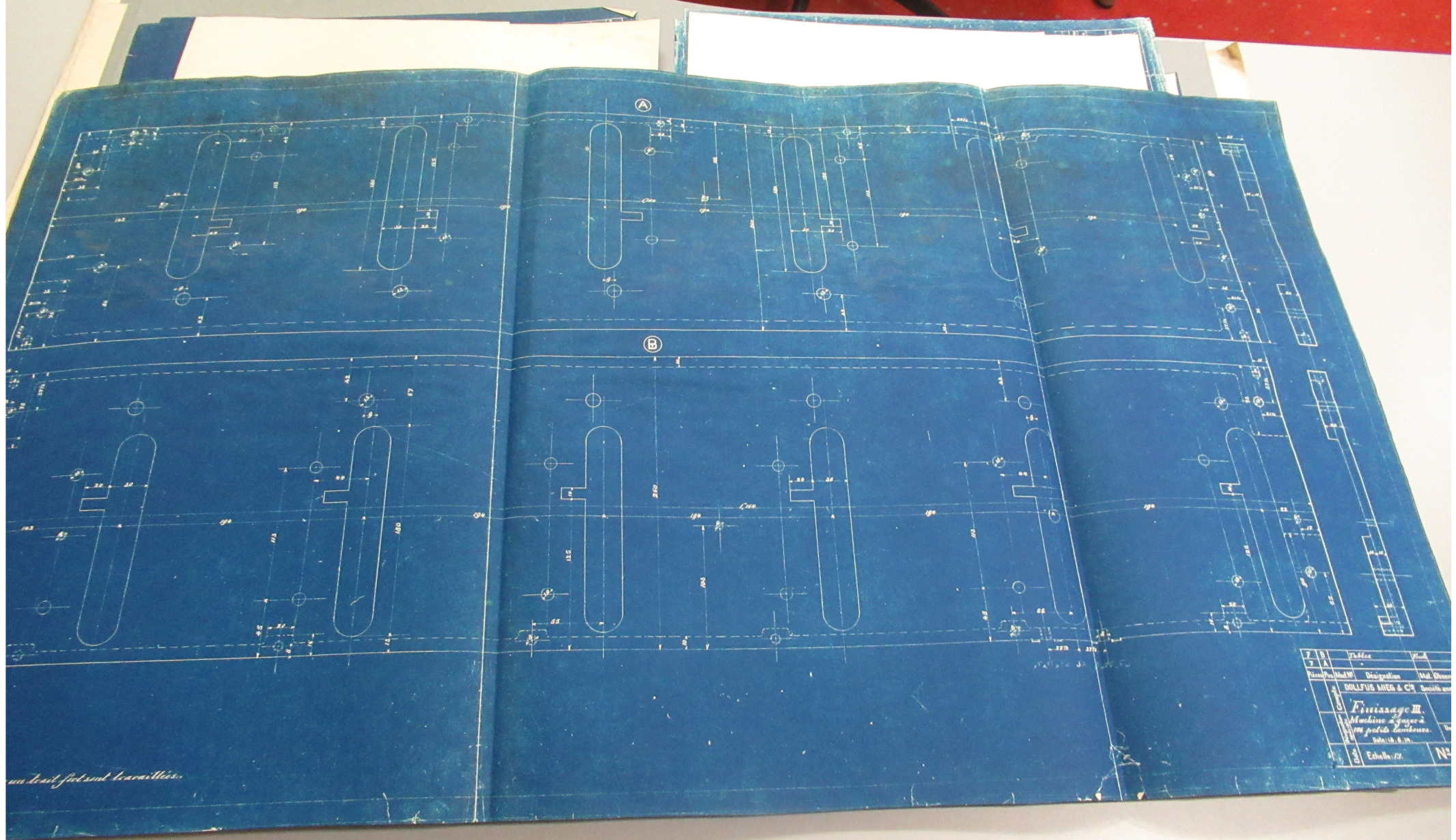

un seul fait sont caractéristiques.

| | | | | |
|-------|-------|-------------------------------|--------------|------|
| 7 | 18 | Détails | | Plan |
| 7 | A | | | |
| Révis | Modif | Designation | Mat. Réserve | |
| 4 | | DOLLFUS MIEG & C ^e | Basile | |
| 5 | | <i>Fraisage III</i> | | |
| 6 | | <i>Machine à vapeur à</i> | | |
| 7 | | <i>un patin horizontal.</i> | | |
| 8 | | Détail: 8.10. | | |
| 9 | | Echelle: 1/1. | | N° |

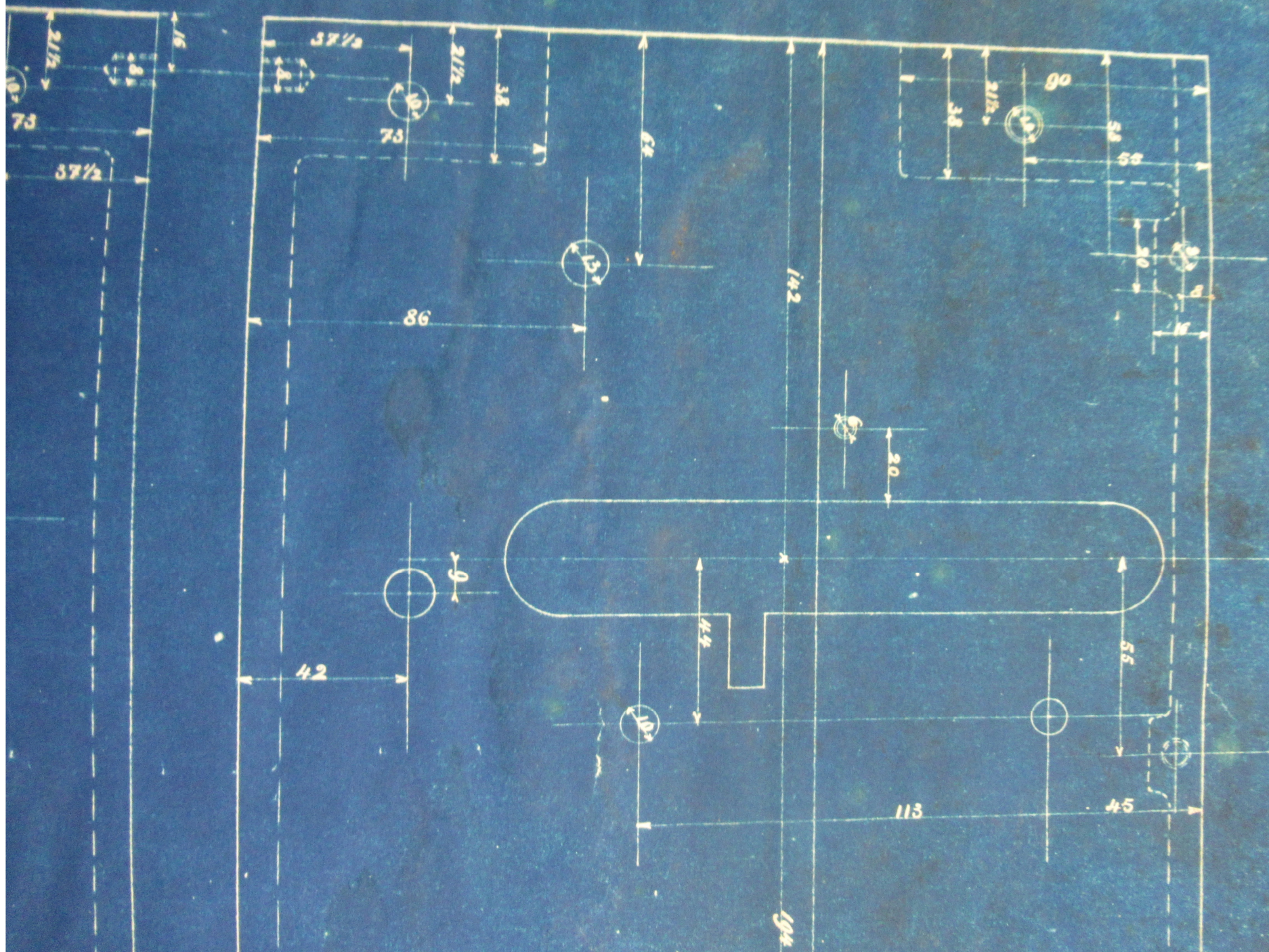

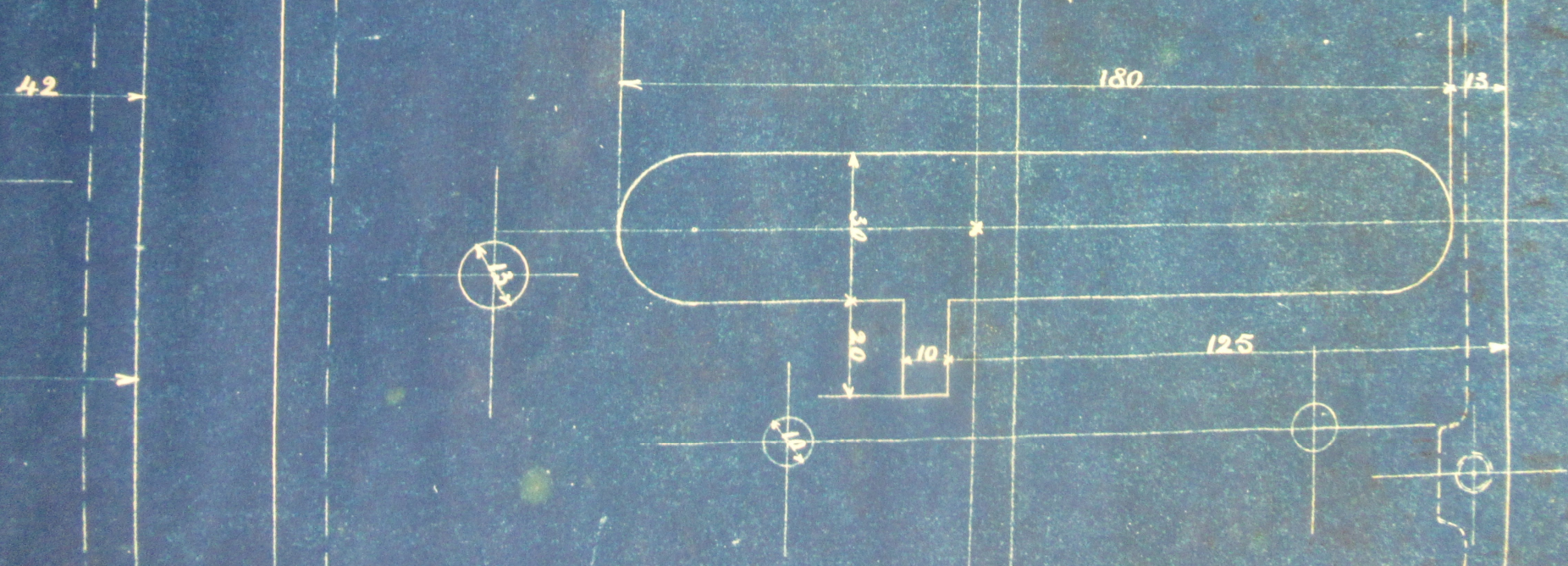
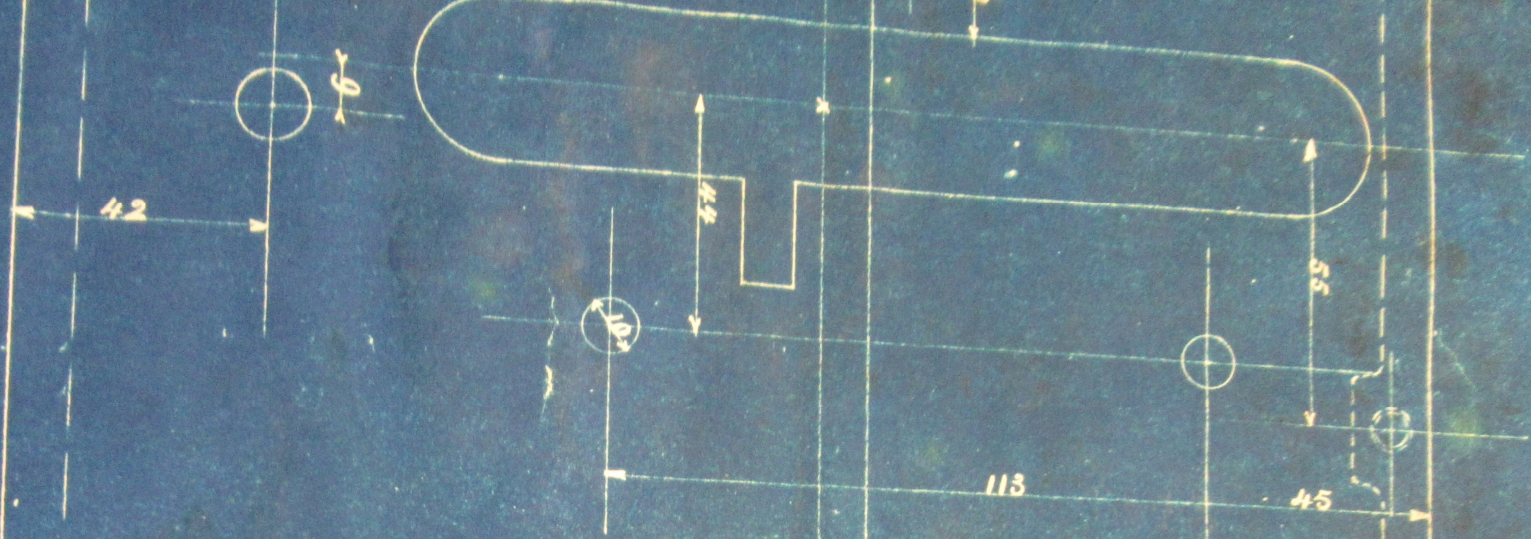

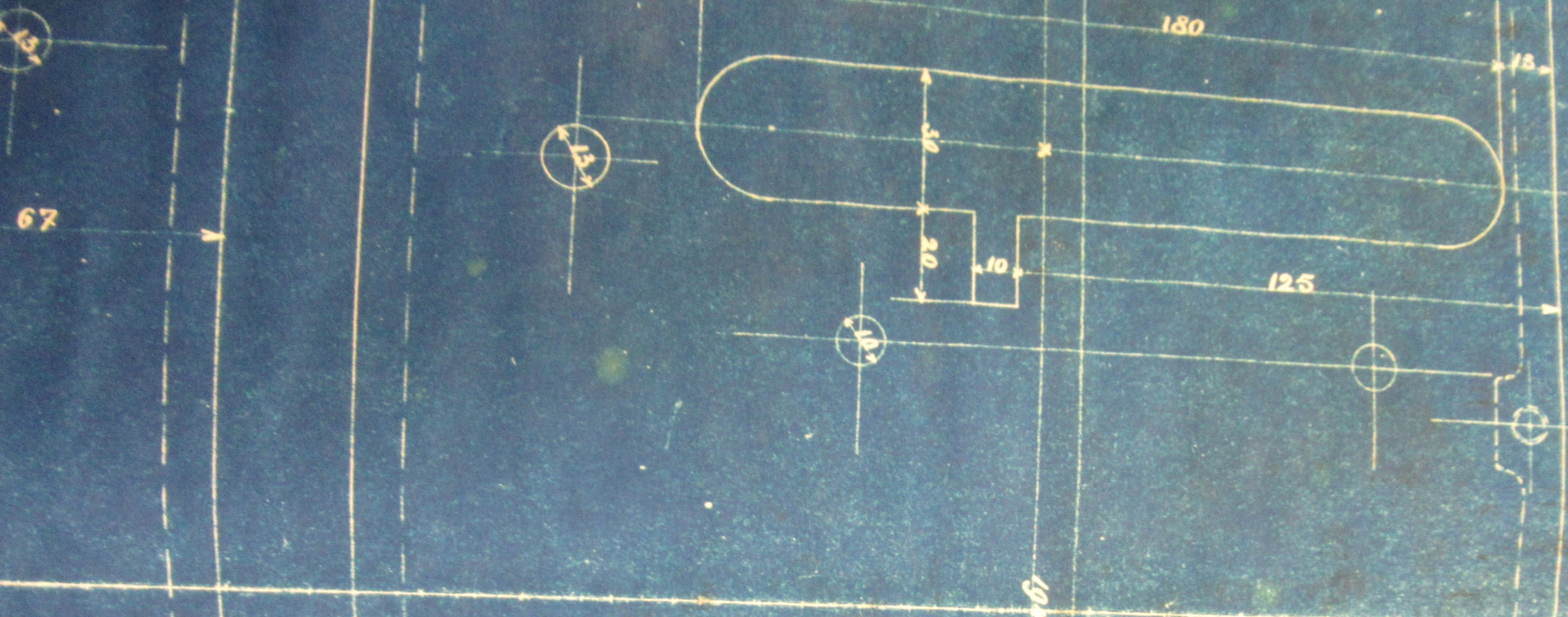

(B)

(A)

(B)

(A)

10

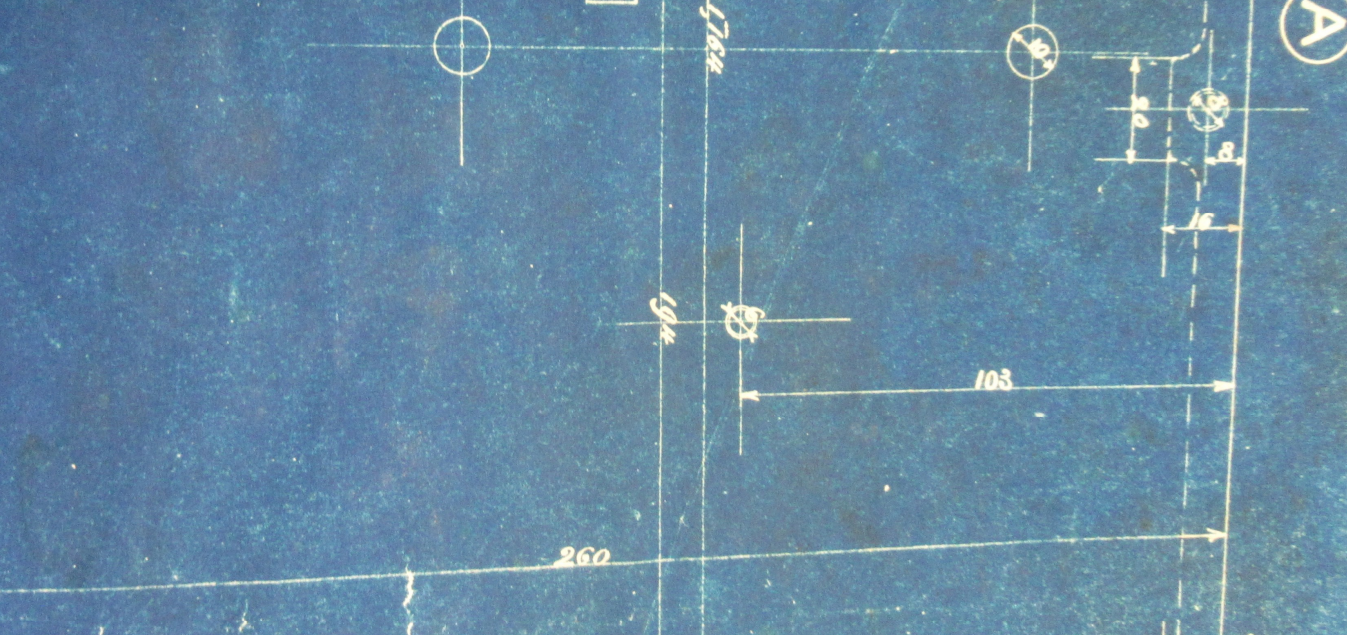

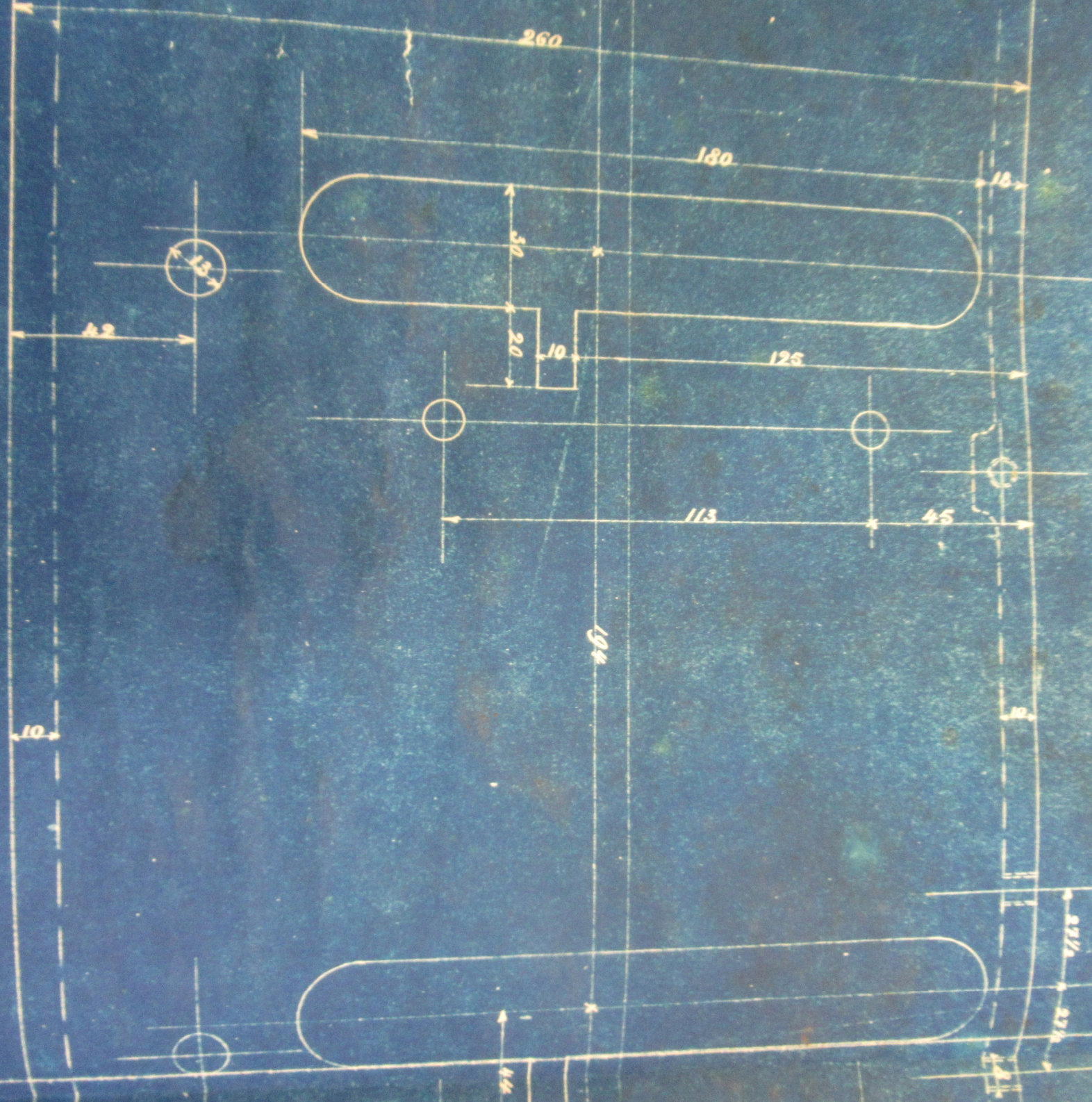

42

10

10

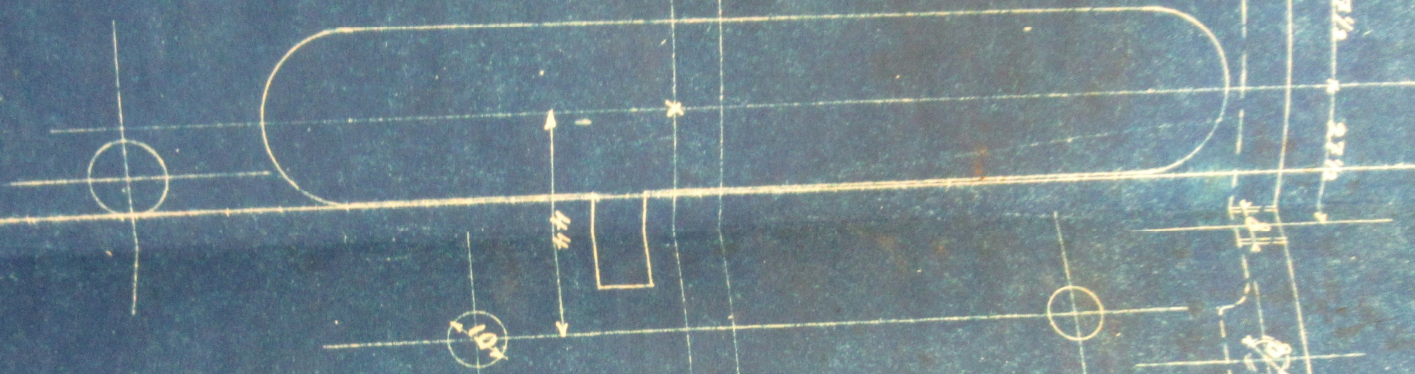

52.4

52.4

10

194

55

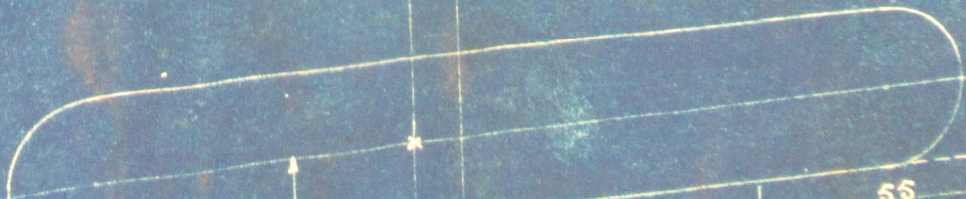

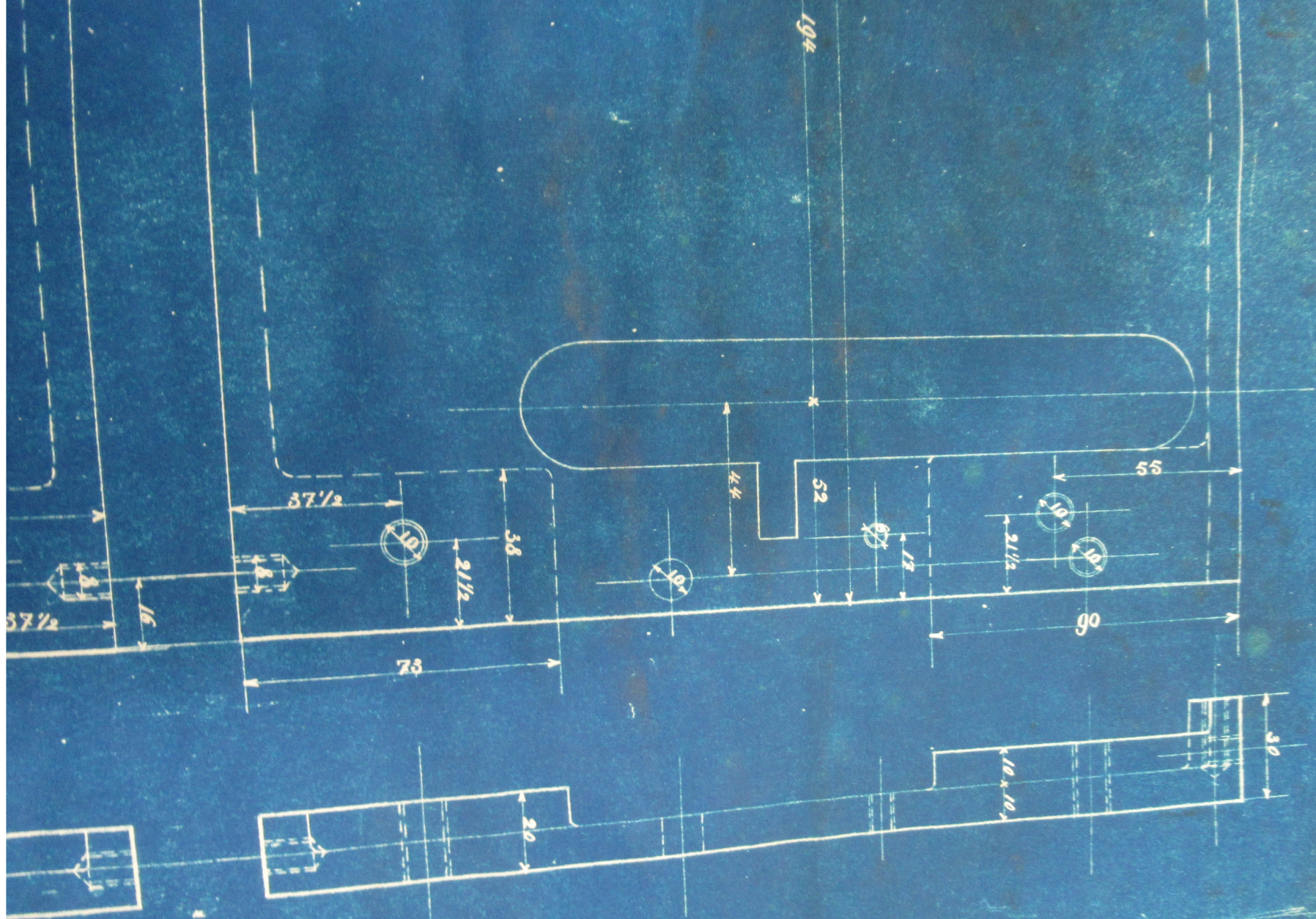

Les parties indiquées par un trait fort sont travaillées.

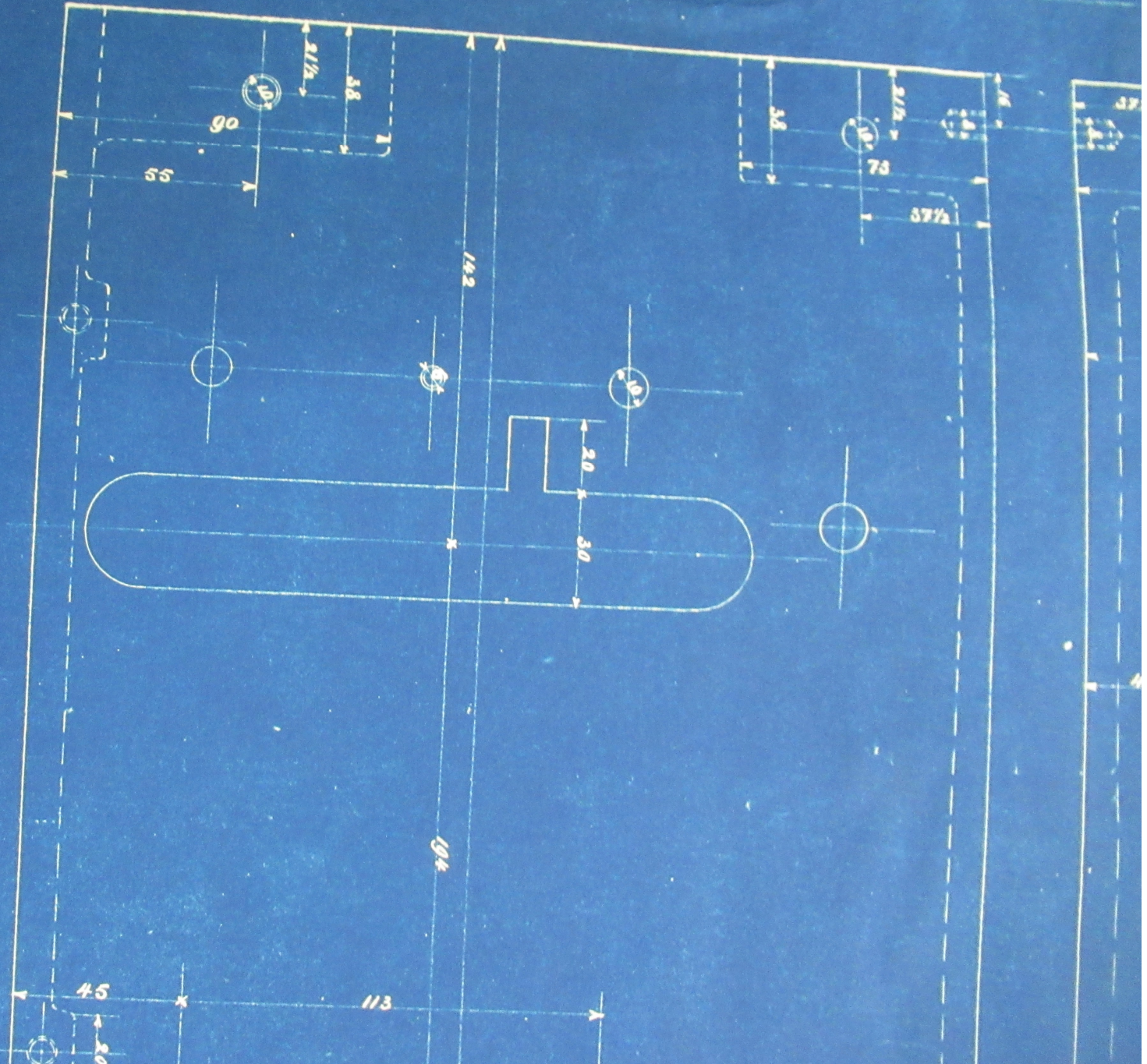

at Fort Smith, Arkansas, Miss.

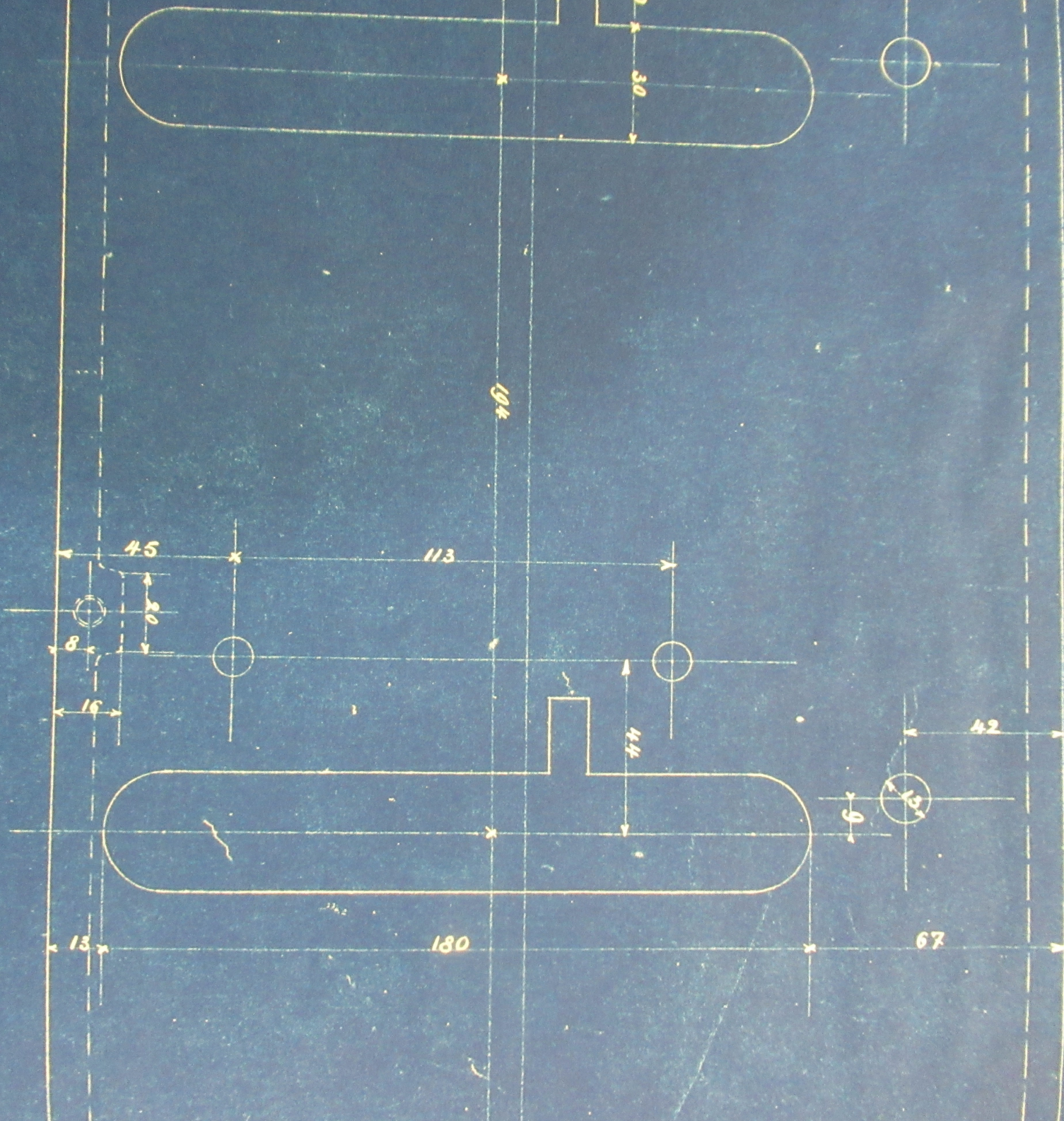



161

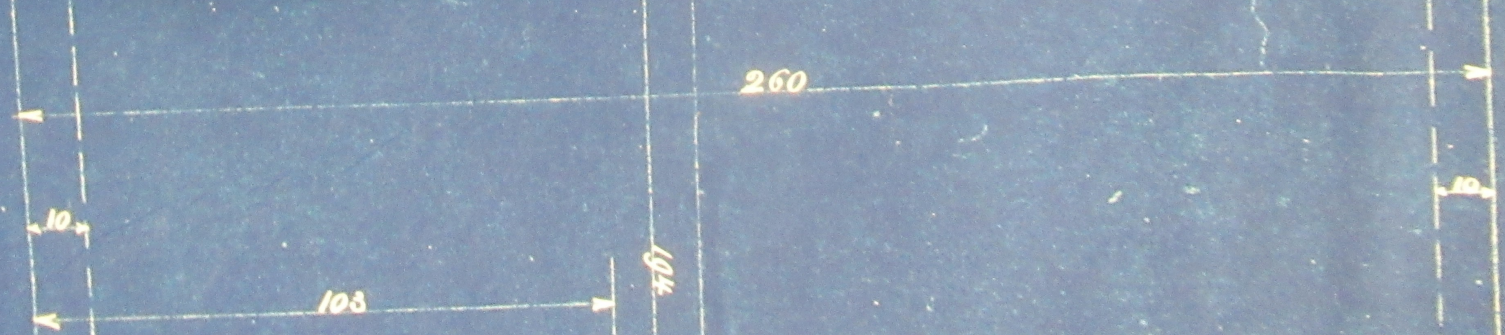
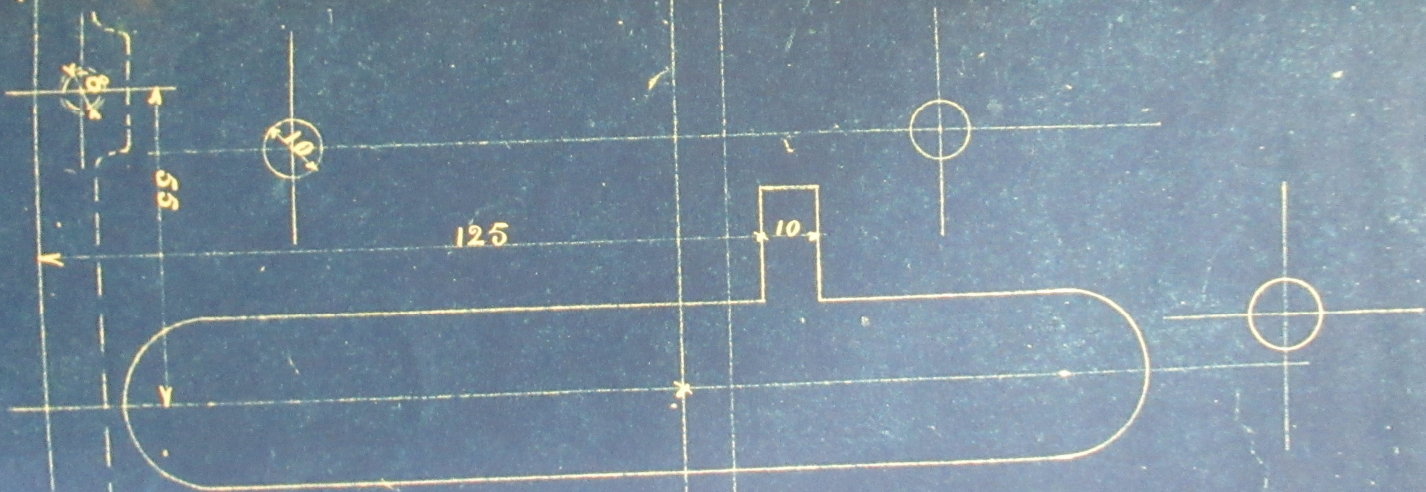

ⓑ

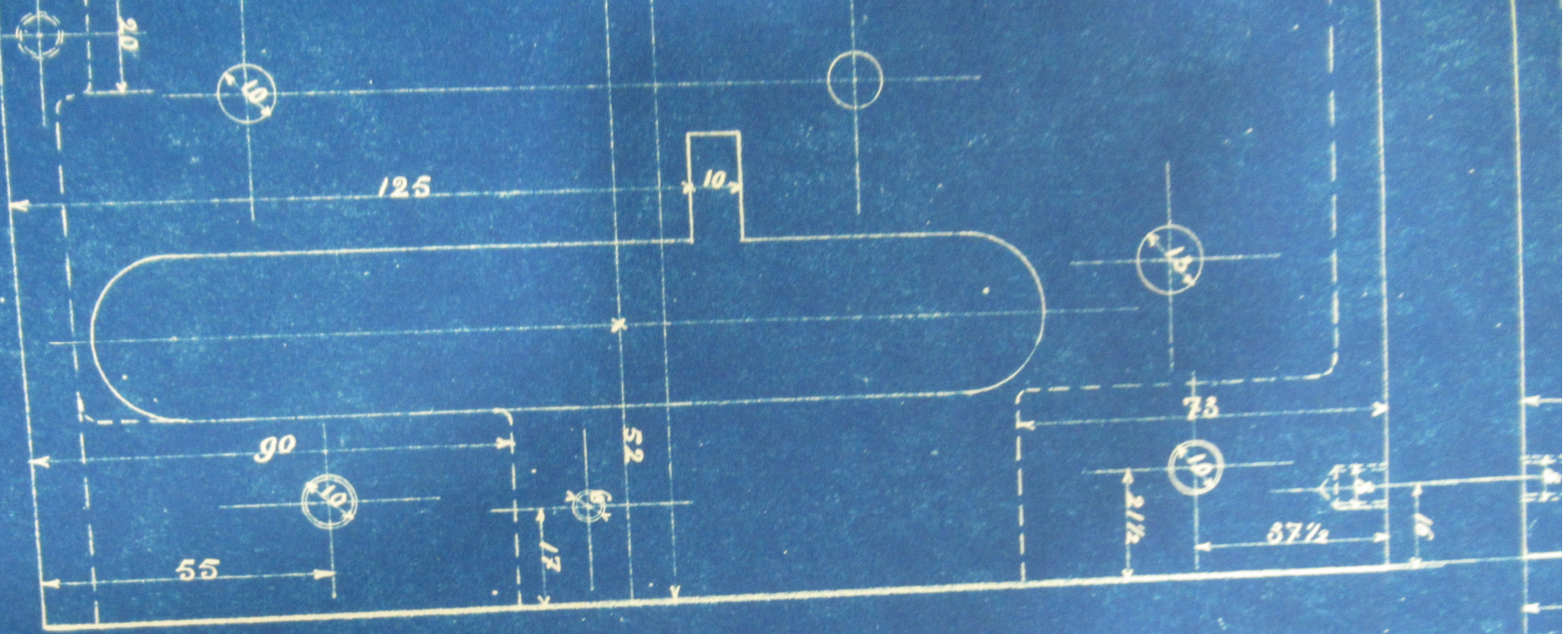

| Pièces | | Tables | | Ends | |
|--------|---|--|-------------|------|-------------|
| 7 | B | | | | |
| 7 | A | | | | |
| | | Mod. N° | Designation | Mat. | Observation |
| | | | | | |
| | | DOLLFUS MIEG & C ^{ie} Société anonyme | | | |

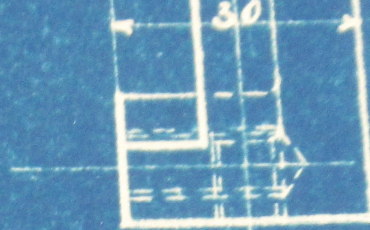
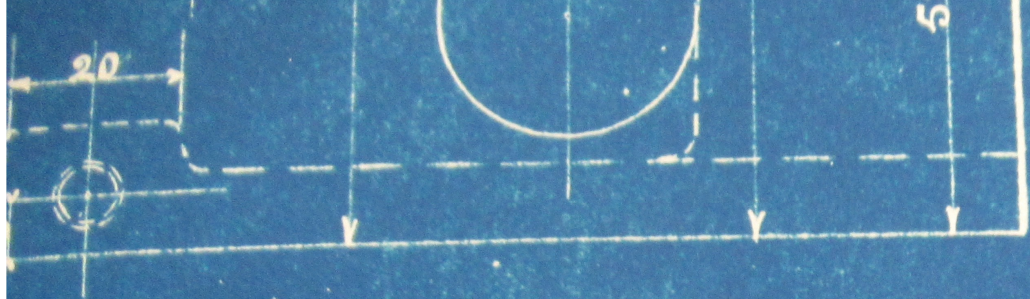

| 7 | B | | Tables. | Feuille |
|--------|----------------------|--|-------------|------------------|
| 7 | A | | " | |
| Pièces | Pos. | Mod. N° | Désignation | Mat. Observation |
| | Compte | DOLLFUS MIEG & C ^{ie} , Société anonyme | | |
| | | <i>Ferrissage III.</i> <i>Machine à gazer à</i> <i>106 petits tambours.</i> <i>Date: 18.8.14.</i> | | |
| | Désignation spéciale | Dessiné par: <i>G. Roy.</i> | | |
| | Date | Echelle: 1/1. | | N° 13235. |