

12 DMC 85 à 92

D.M.C

PLANS D'ENSEMBLE DES ATELIERS

Année 1933

—

MULHOUSE

Teinturerie I

Teinturerie II

Teinturerie II 1^{er} Etage

Blanchiment I

Blanchiment II

Teinturerie

Blanchiment

Services divers

BELFORT

8 plans

M D N C 92

BATIMENT DE SERVICES DIVERS POUR BELFORT.

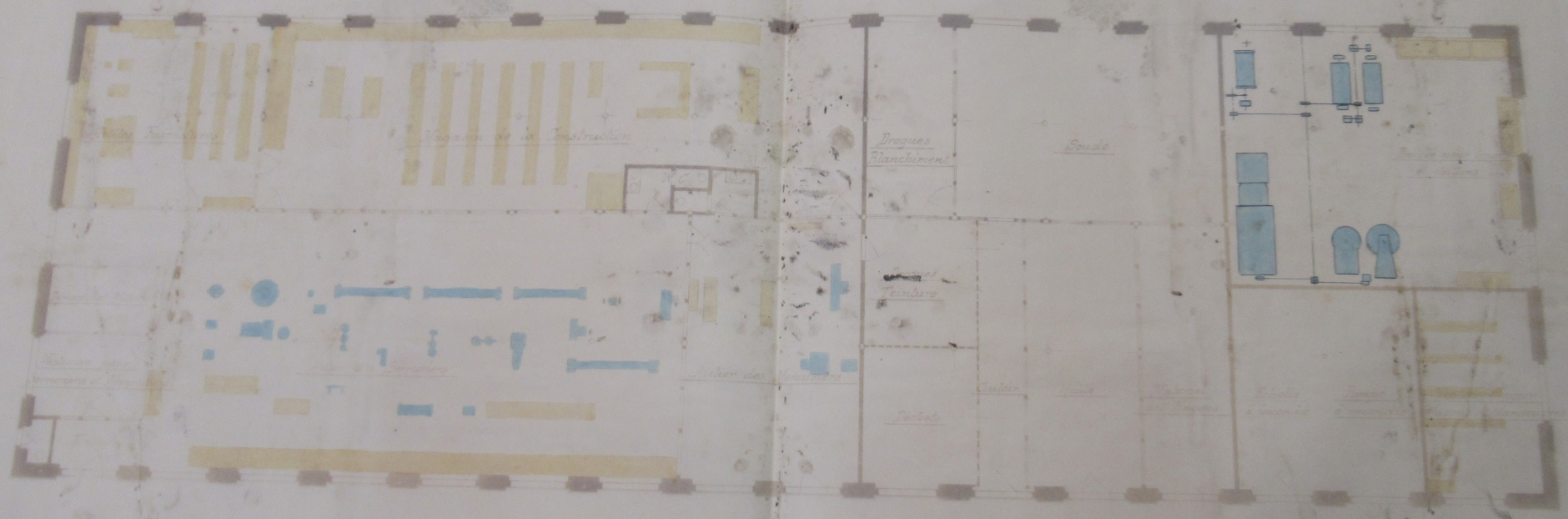

BATIMENT DE SERVICES DIVERS POUR BELFORT.

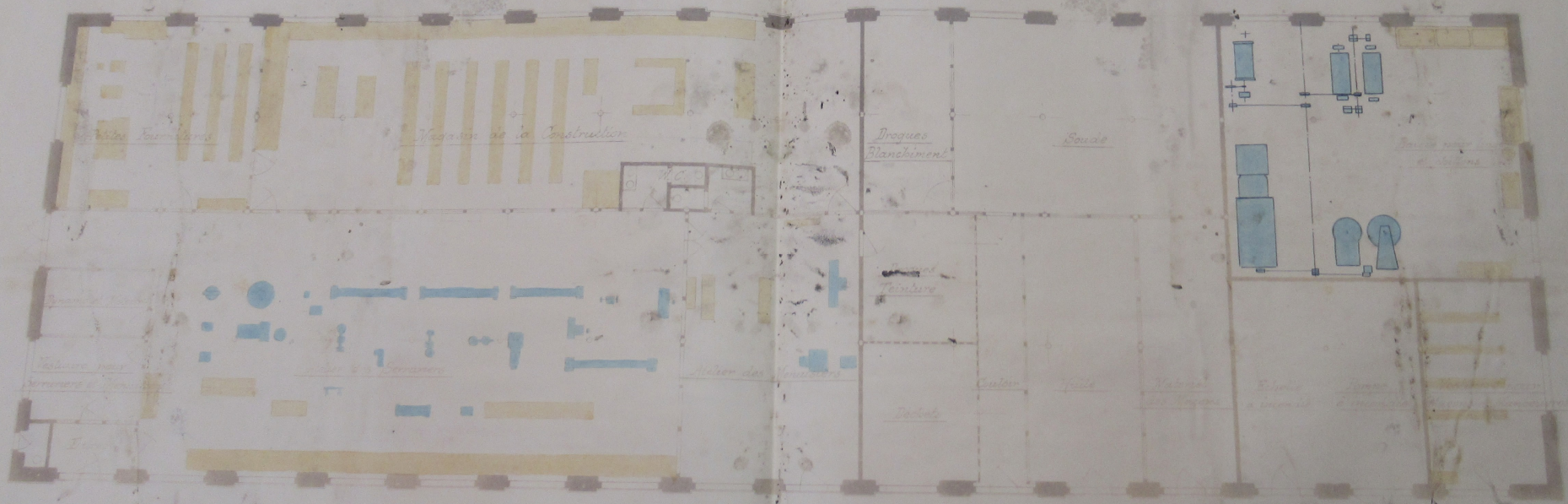

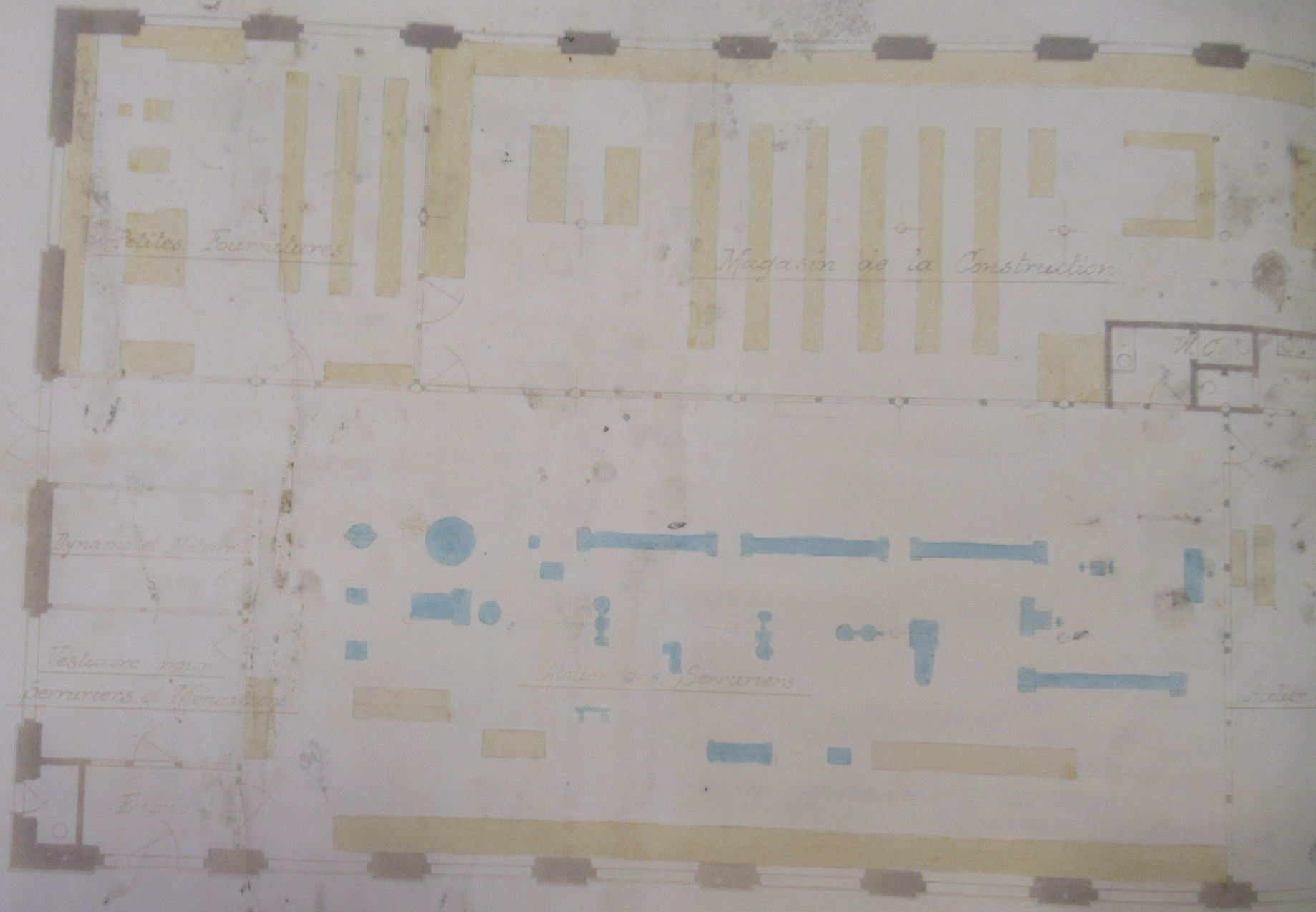

Petites Fourneaux

Magasin de la Construction

Dynamo et Vapeur

*Vestiaire pour
Serruriers et Menuisiers*

Atelier des Serruriers

H.C.

Entree

Atelier de...

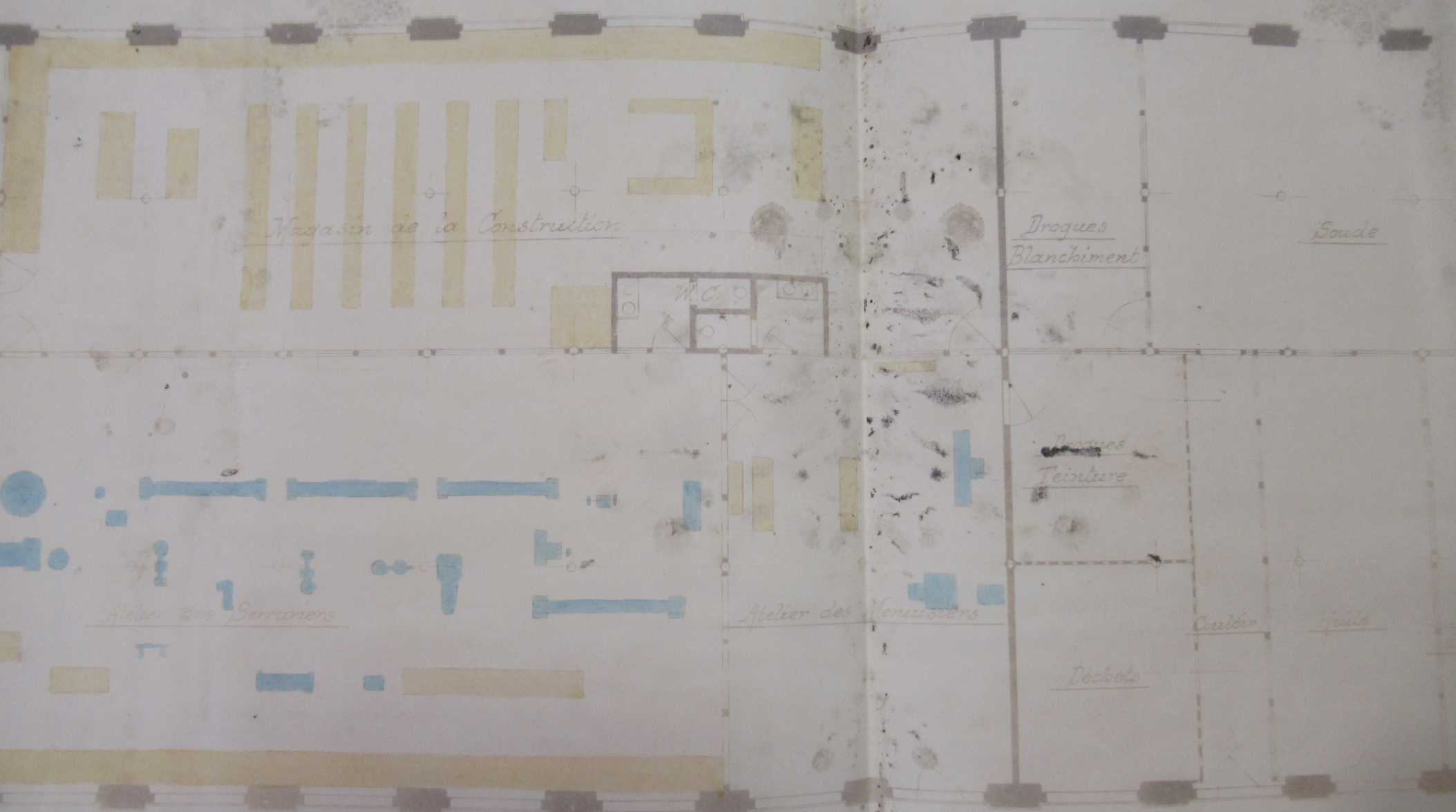

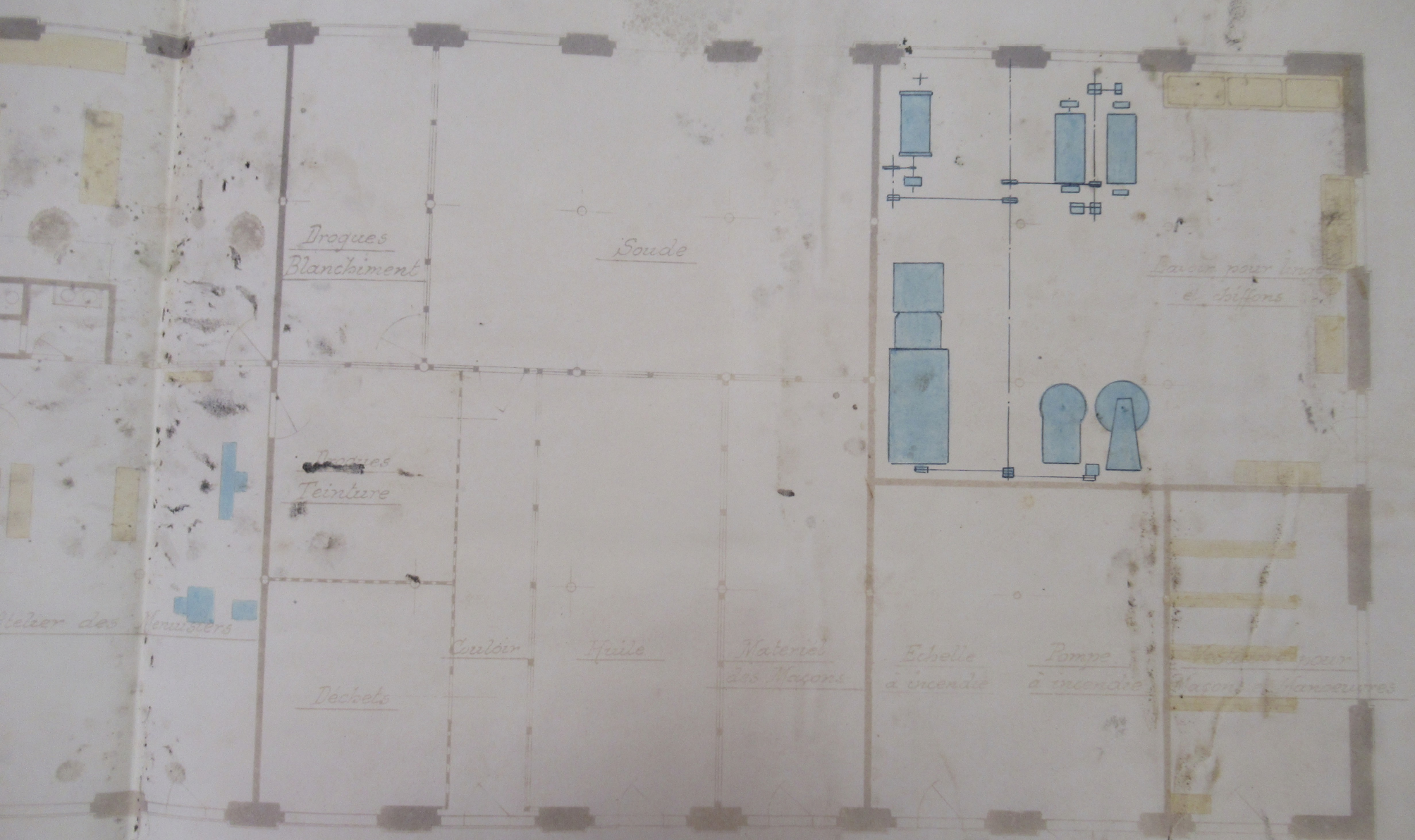



Petites Fournitures

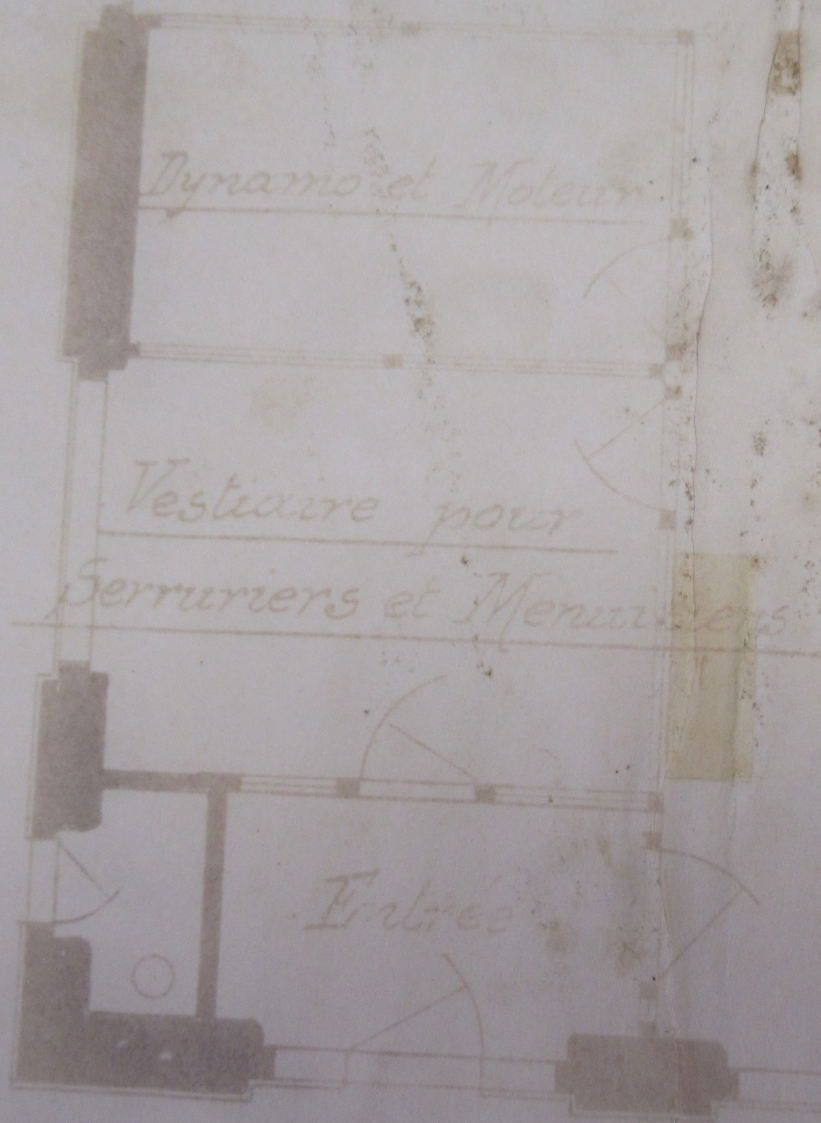

Dynamo et Moteur

*Vestiaire pour
Serruriers et Menuisiers*

Entrée



Atelier



Dynamote et Moteur

*Vestiaire pour
Serruriers et Menuisiers*

Trabée

bleu

ur

Serruriers

Atelier des Serruriers

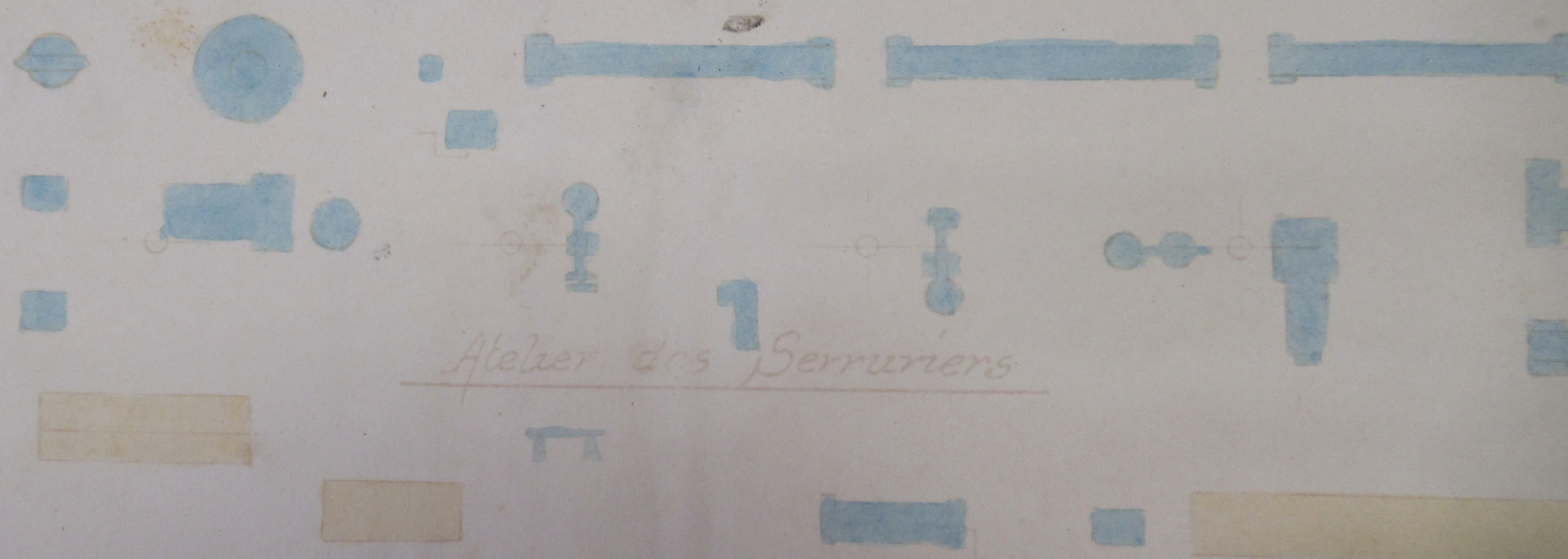

Handwritten notes at the top of the page, partially obscured by yellow tape.

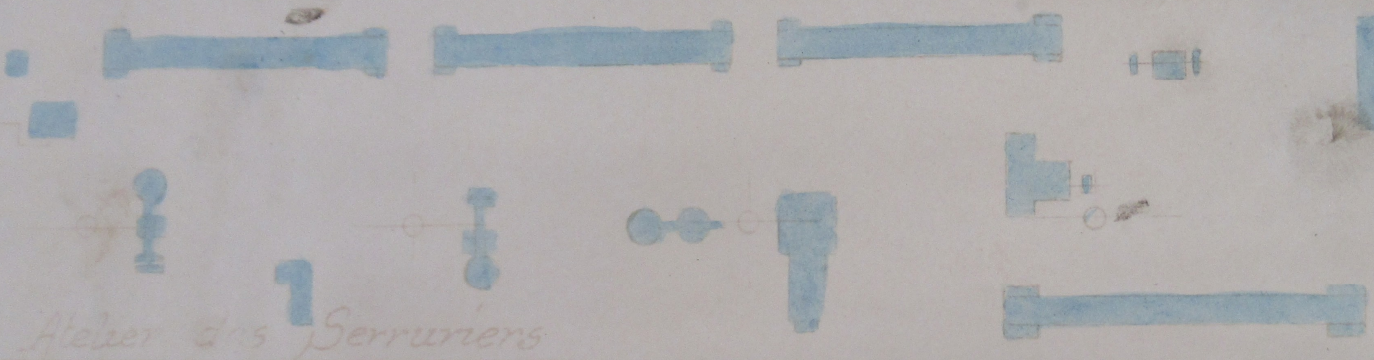
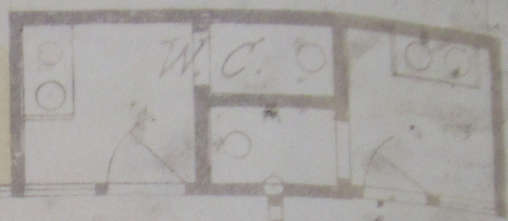

Atelier des Serruriers

Atelier des Menuisiers

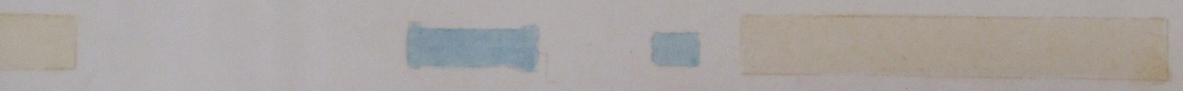
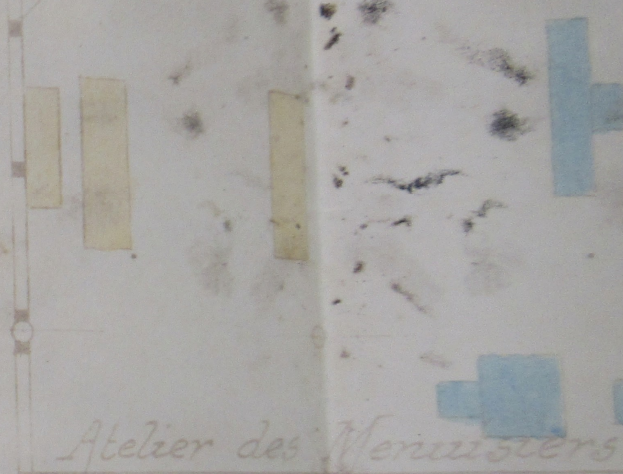



~~Produces~~
Teinture

Atelier des Menuisiers

Déchets

Coulée

Fournitures

Magasin de la Construction

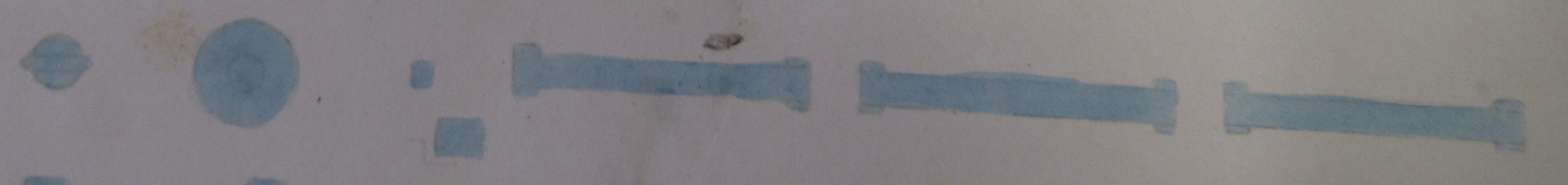
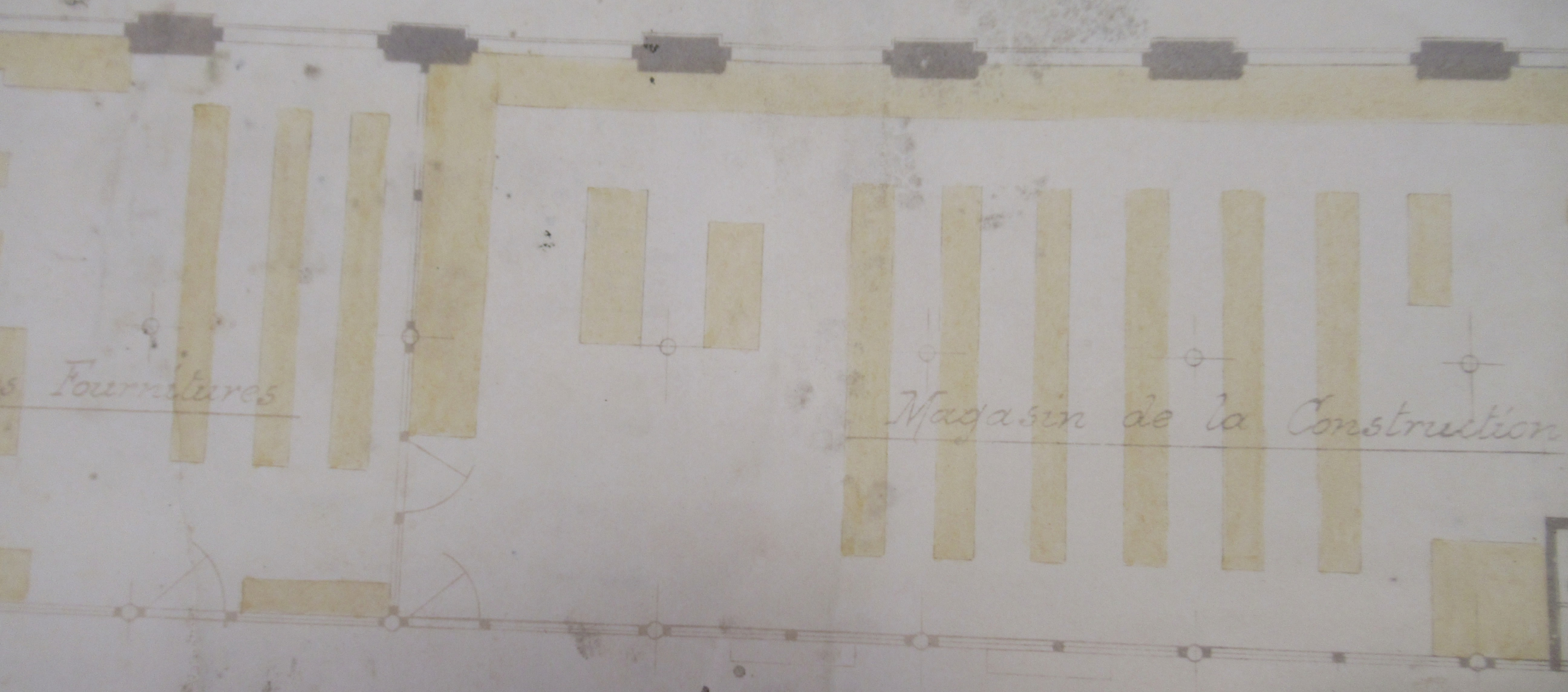

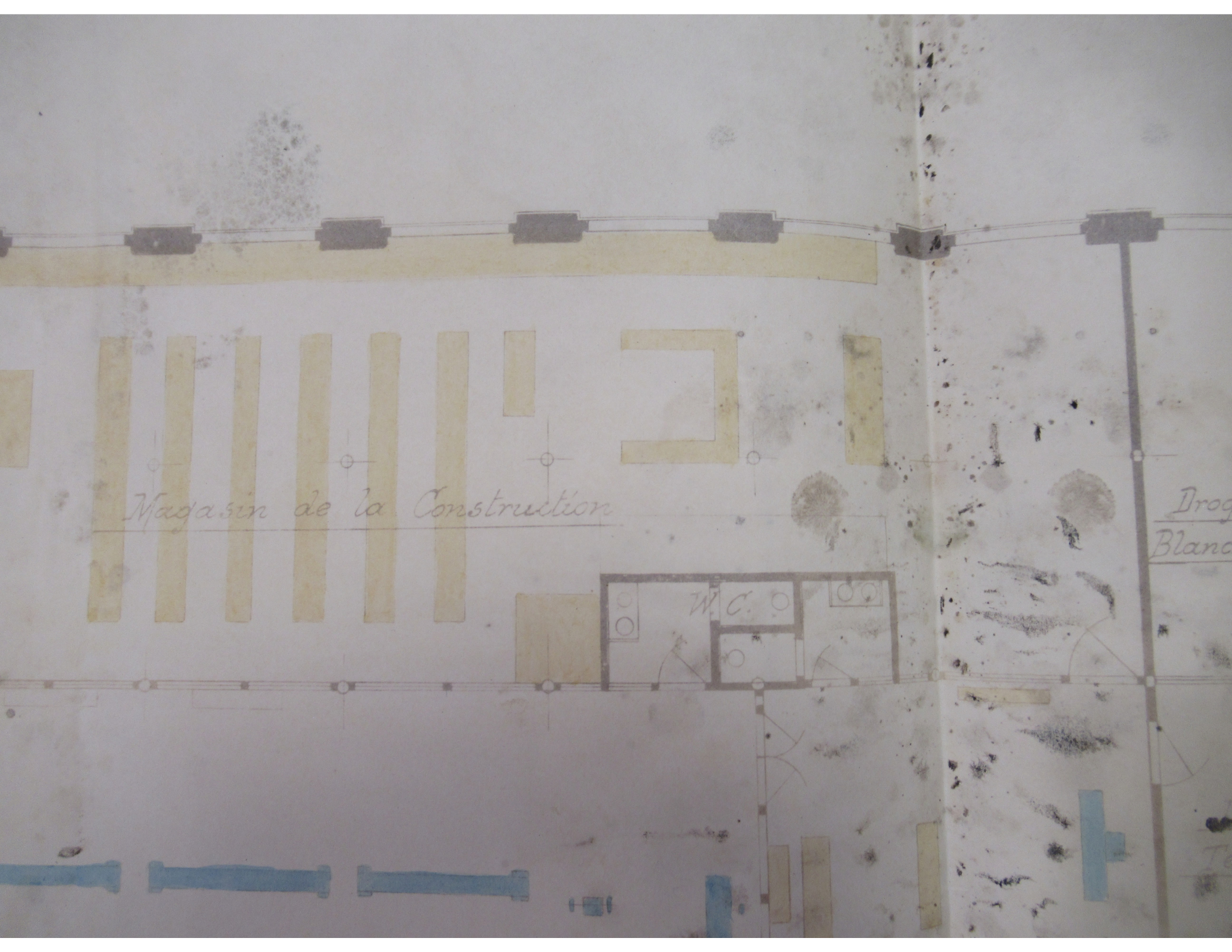

Magasin de la Construction

*Drog
Blanc*

W.C.

MILITARY



Drogues
Blanchiment

~~Drogues~~
Teinture

Déchets

Embouir

Huile

Soude

Matériel
des Magasins

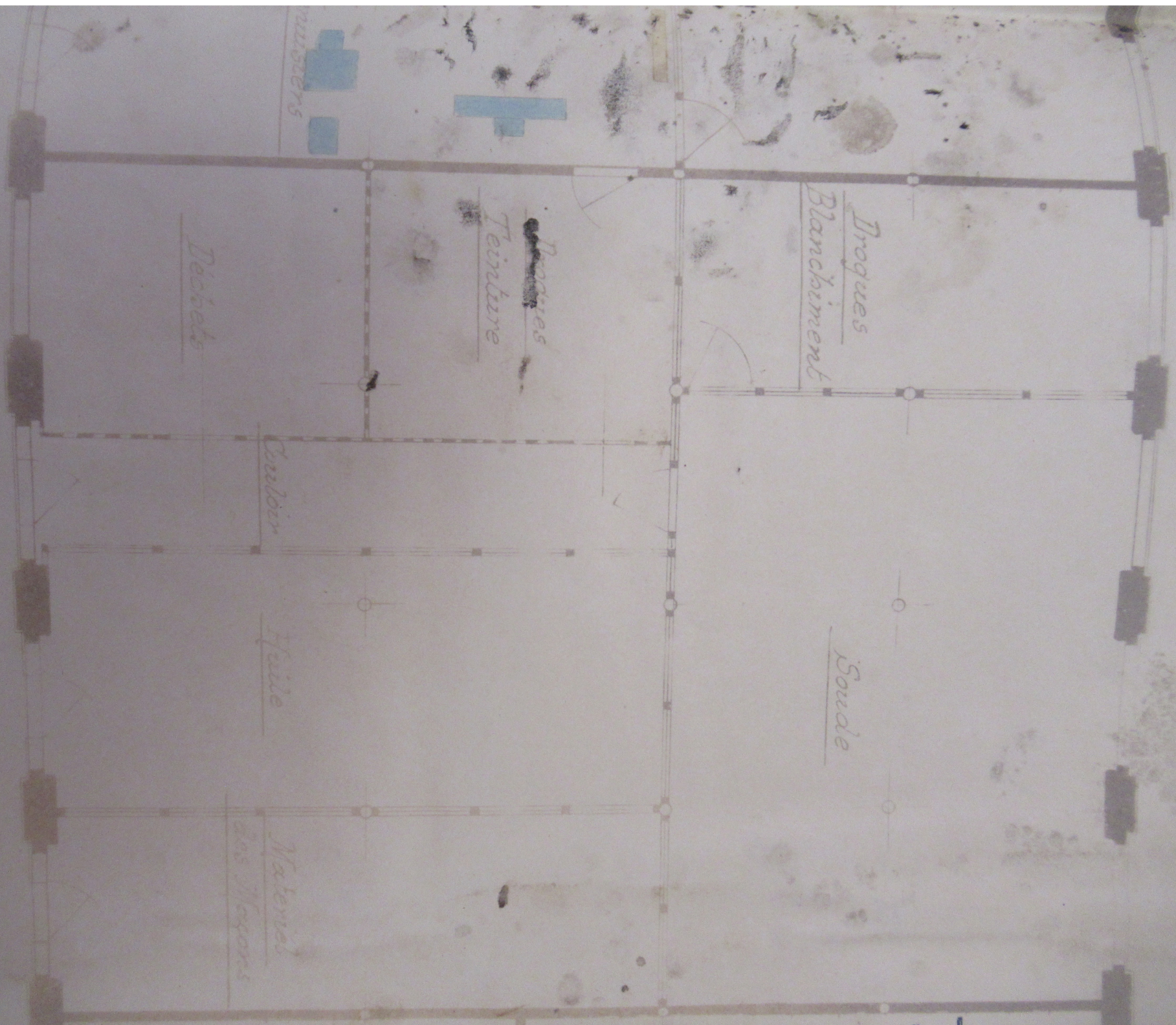

Soude

Huile

Matériel
des Ateliers

Echelle
à incendie

Pompe
à incendie

Ateliers

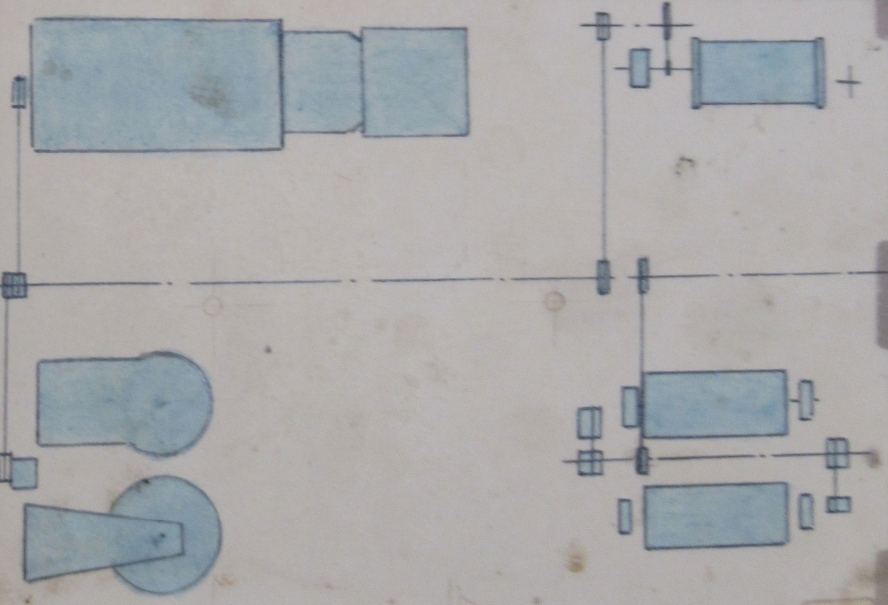

Barres pour
et chiffons

portes
nature

ets

Carrelain

Huile

Matériel
des Maçons

Echelle
à incendie

Pompe
à incen



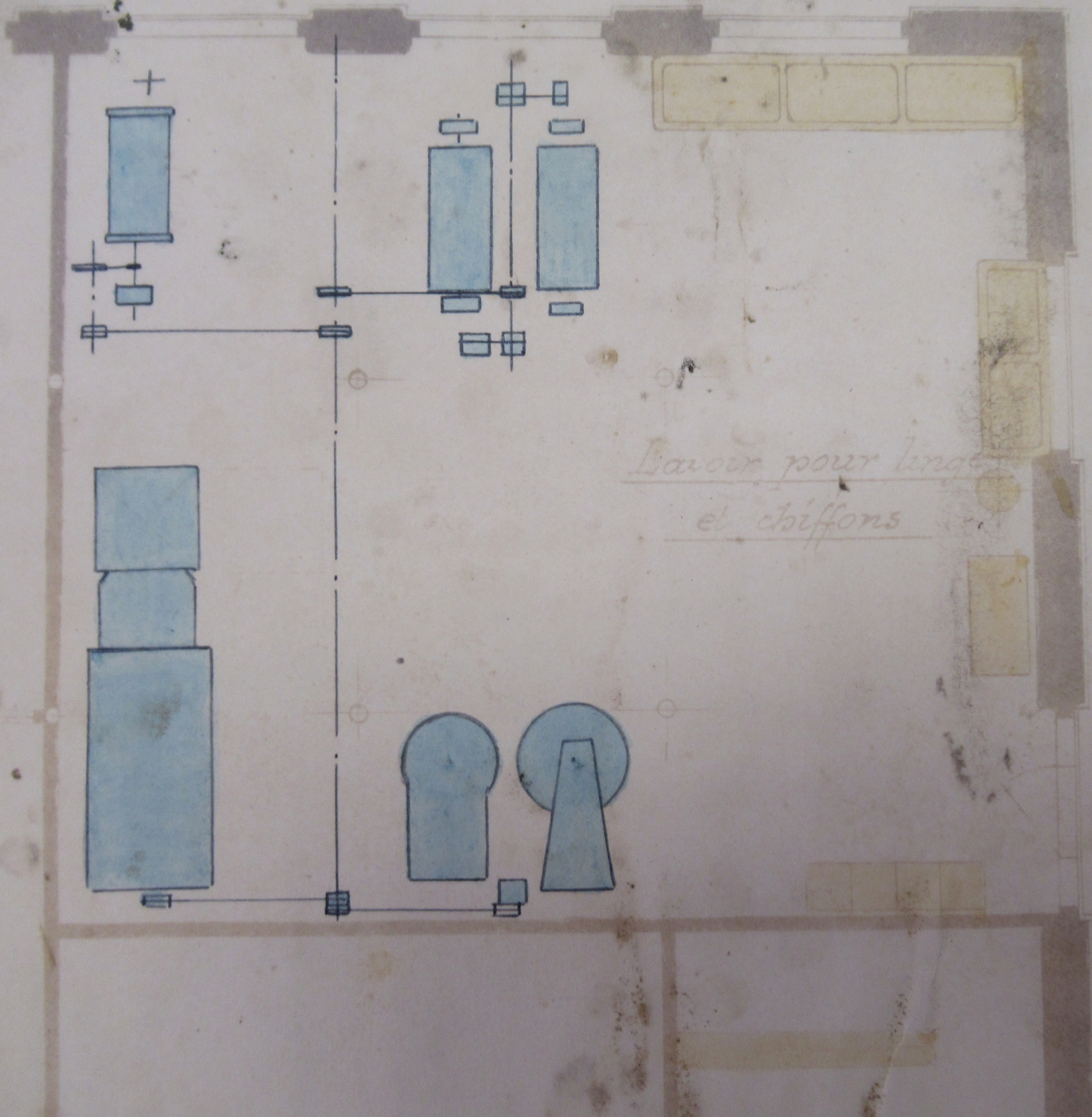

*Lavoir pour linge
et chiffons*

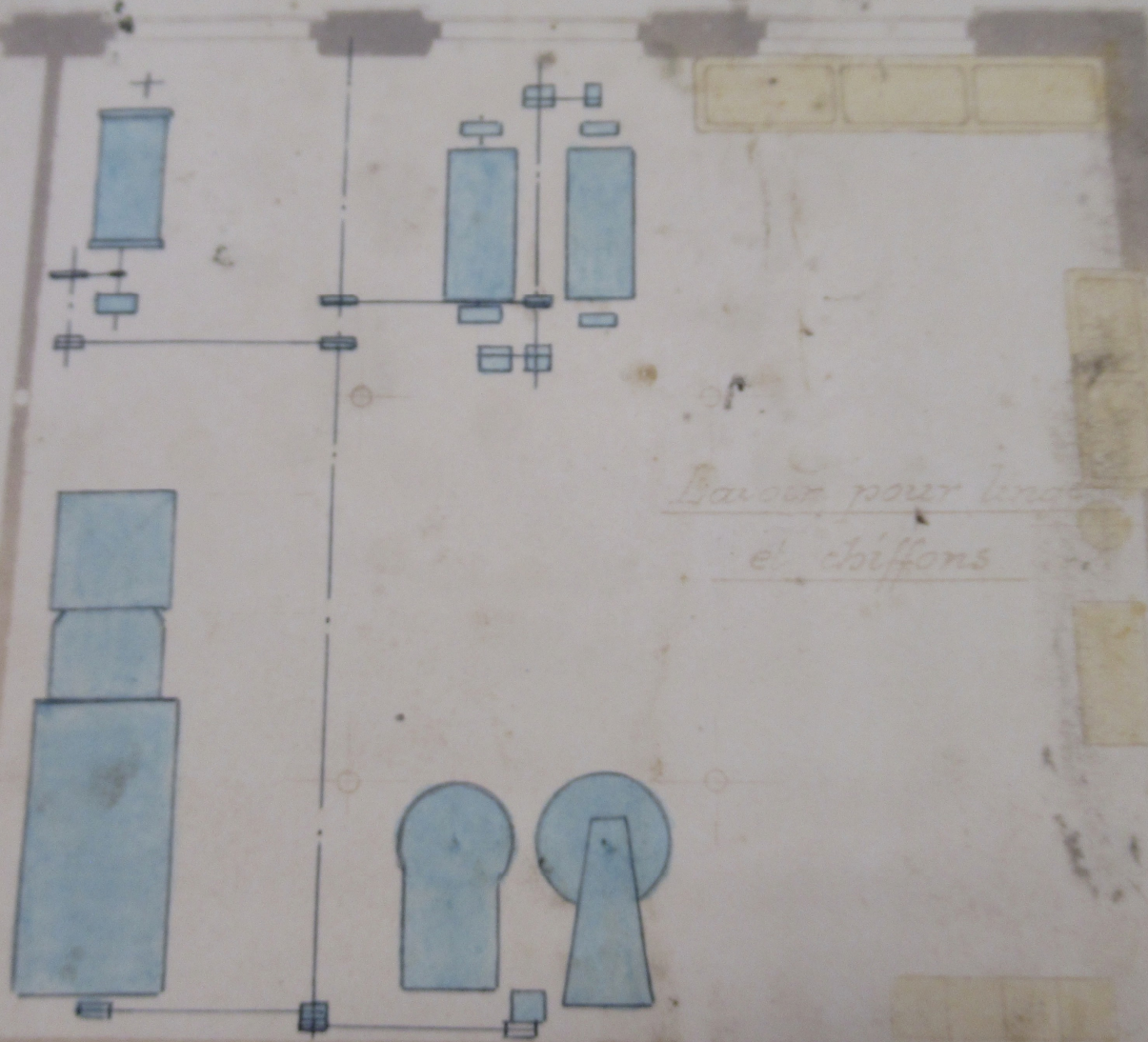

*Lavoir pour linge
et chiffons*

*Echelle
à incendie*

*Pompe
à incendie*

*Vestibule pour
Maçon et Manœuvres*

Les
vans

Etabelle
à grande

Pompe
à mercure

Passages pour
Mascos et hamourses

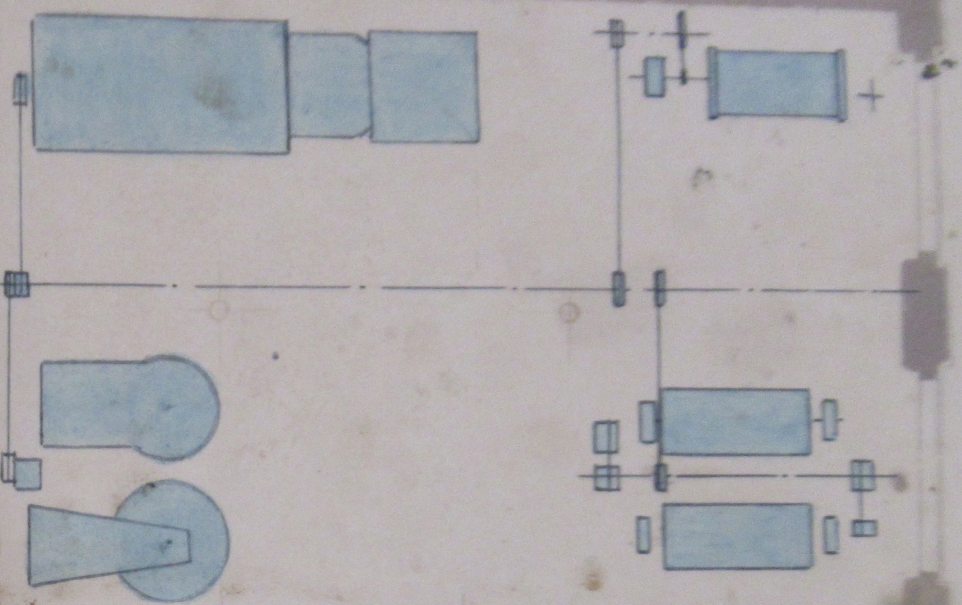

Passages pour
et chifons

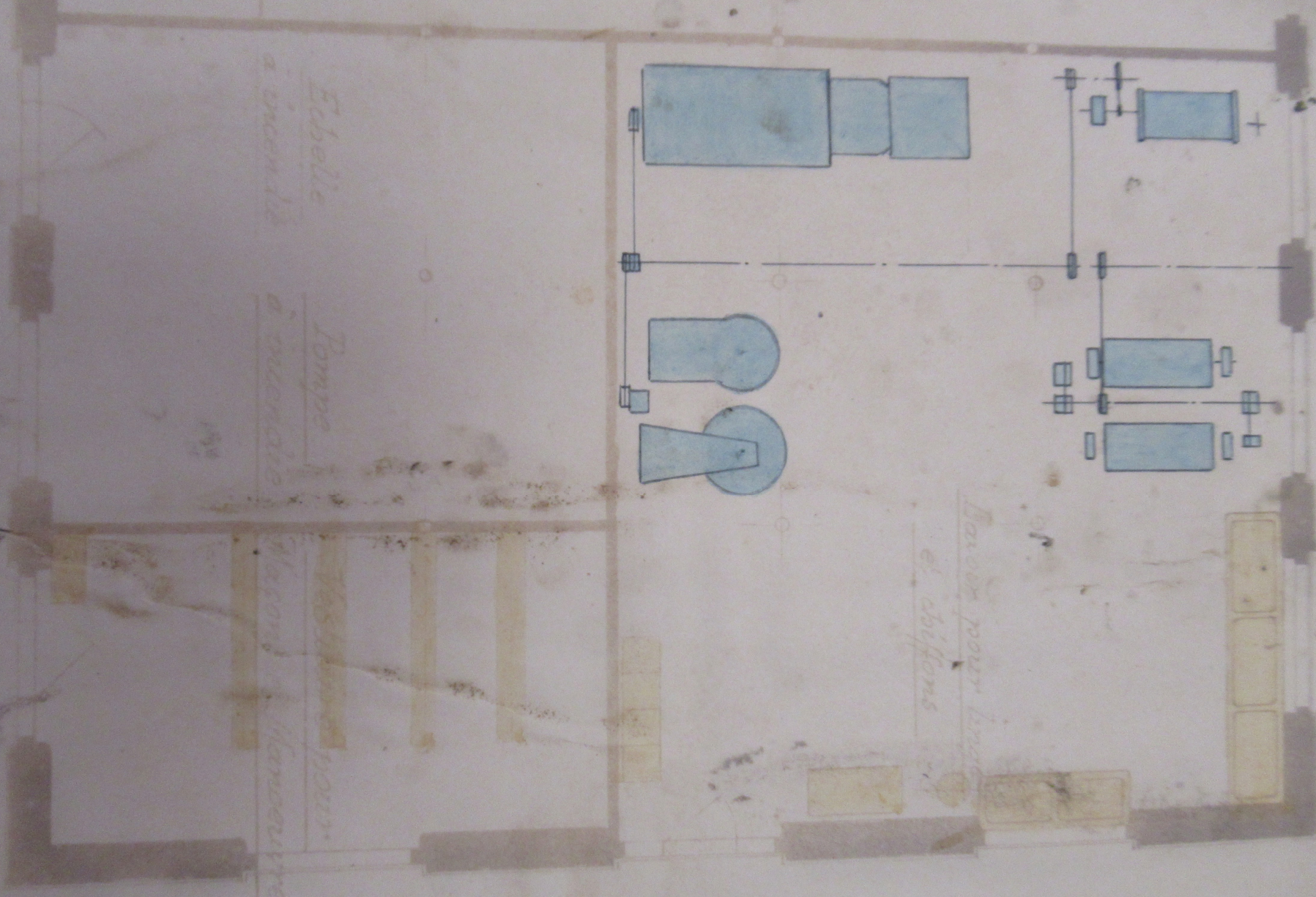

échelle: 1/200

1870-71

— BÂTIMENT DE SERVICES DIVERS pour BELFORT. —

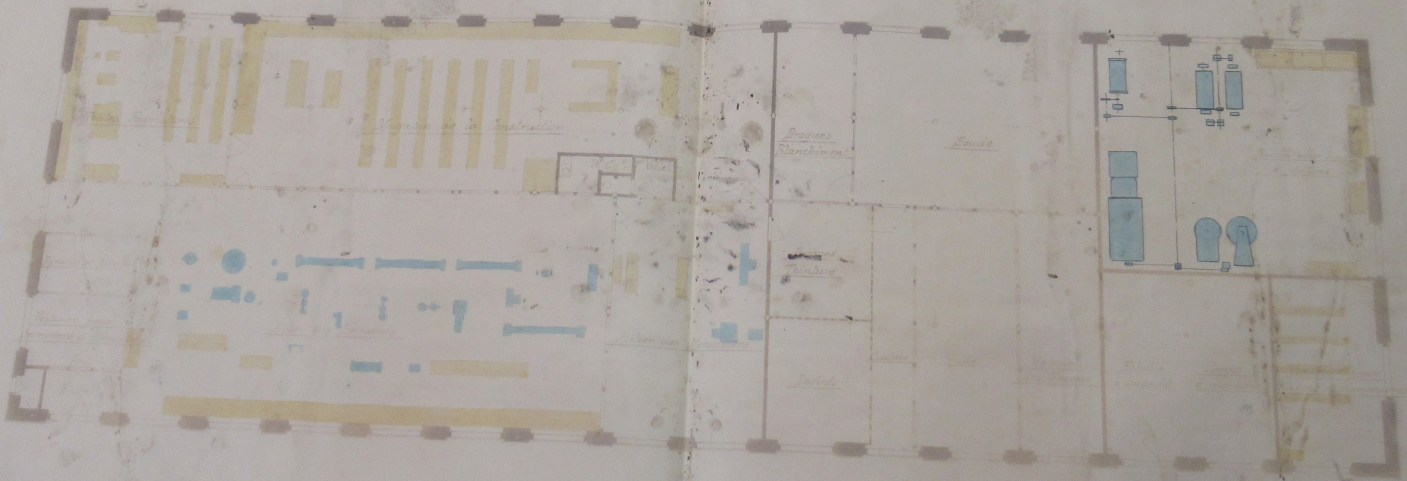

échelle: 1/200